

Type	A	B	C	D
TP 6220	1141	971	349	591

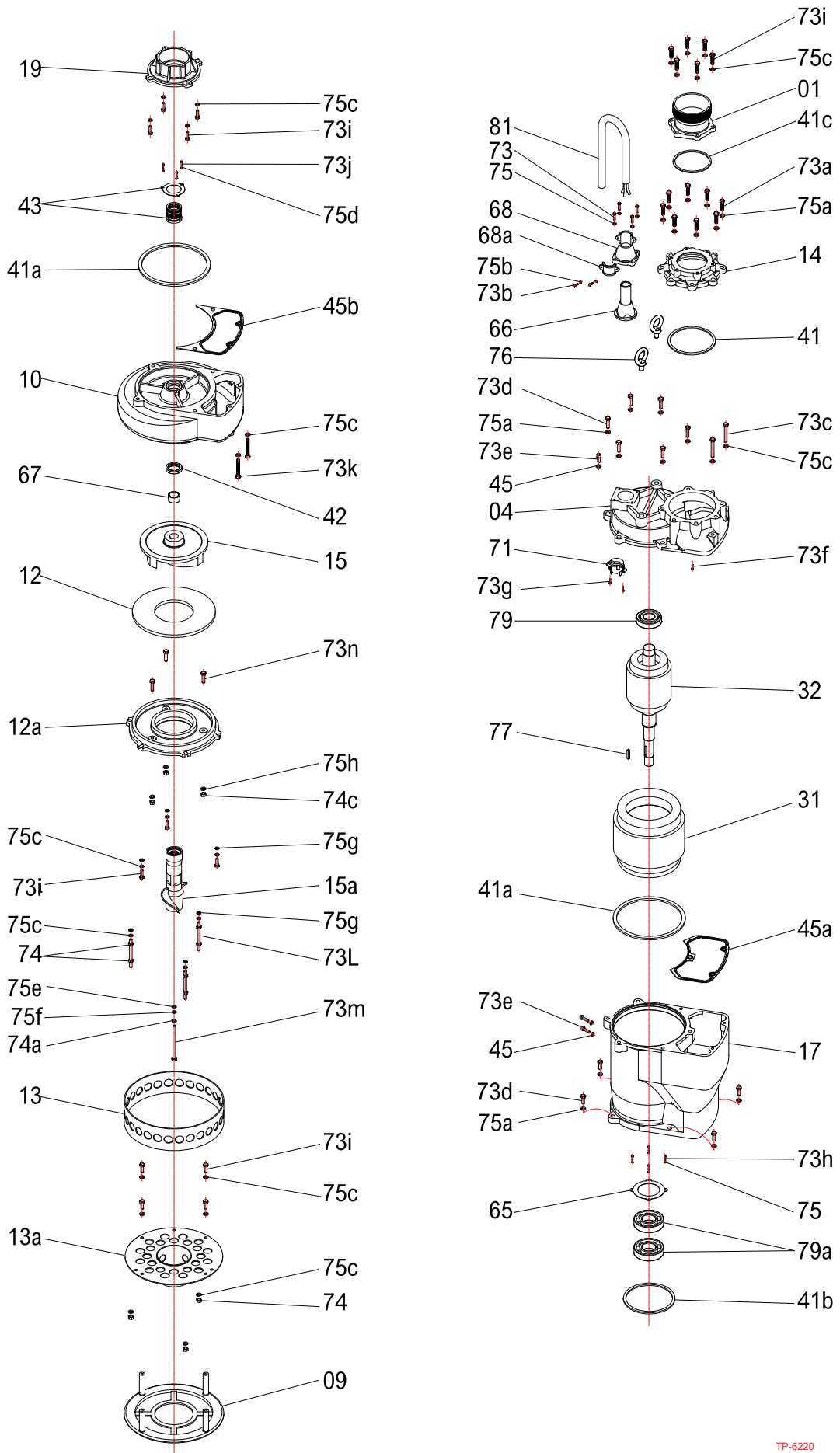

Index	Code NO	Description	Q'ty	Size	Material
01	01360953	Discharge head	1	6"	FC-20
04	0436TP2250	Upper cover	1		FCD-45
09	0935TP2250	Base plate	1		FCD-45
10	1035TP2250	Pump casing	1		FCD-45
12	1241TP2250	Wear plate	1		HCR
12a	1236TP2250	Inlet plate	1		FC-20
13	1330TP2250	Strainer	1		SC
13a	1335TP2250	Strainer	1		FCD-45
14	1436103	Frange	1		FC-20
15	1541TP6220335	Impeller	1		HCR
15a	1541TP2250	Agitator	1		HCR
17	1736TP2250	Motor frame	1		FC-25
19	1936TP2250	Bearing bracket	1		FC-20
31	313400E16E6	Stator	1	310*175*160L	
32	323TP2200	Shaft/Rotor without Bearing	1	175*160L	SUS-410
41	411055-02	O'ring	1	5.7MM*215	N-70
41a	411035-09	O'ring	2	4MM*300	N-70
41b	411031-14	O'ring	1	3.1MM*195	N-70
42	4214350-01	Oil seal	1	50*70*12	NBR
43	432245-1	Mech.seal	1	BED560-045	
45	459010	Gasket	3		NBR
45a	451340220	Gasket	1		NBR
45b	453338220	Gasket	1		NBR
65	65309	Shim	1		SS-400
66	66725270	Cable gland	1		NBR
67	674350-01	Shaft sleeve	1	40*50*28L	SUS-304
68	68364	Gland Holder	1		FC-20
68a	68364A	Gland Holder	1		FC-20
71	7128-09	Thermal protector	1	KA315 JXBN00	
73	73431080351	Screw	4	Flat hex.M8*35	SUS-304
73a	73431160501	Screw	8	Flat hex.M16*50	SUS-304
73b	73431060201	Screw	2	Flat hex.M6*20	SUS-304
73c	73431120901	Screw	2	Flat hex.M12*90	SUS-304
73d	73431160601	Screw	10	Flat hex.M16*60	SUS-304
73e	73432100161	Screw	3	Socket hex.M10*16	SUS-304
73f	73303040081	Screw	1	Round crossM4*8	SC
73g	73303050121	Screw	2	CrossM4*12	SC
73h	73431080151	Screw	4	Flat hex.M8*15	SUS-304
73i	73431120351	Screw	13	Flat hex.M12*35	SUS-304
73j	73431050121	Screw	3	Flat hex.M5*12	SUS-304
73k	73431121701	Screw	2	Flat hex.M12*170	SUS-304
73l	73437121461	Screw	3	Twin head.M12*146	SUS-304
73m	73431202301	Screw	1	Flat hex.M20*230	SUS-304
73n	73431100501	Screw	3	Flat hex.M10*50	SUS-304
74	7414312	Nut	9	M12	SUS-304
74a	7414320	Nut	1	M20	SUS-304
74c	7414310	Nut	3	M10	SUS-304
75	753430008-01	Spring washer	8	M8	SUS-304
75a	753430016-01	Spring washer	18	M16	SUS-304
75b	753430006-01	Spring washer	2	M6	SUS-304
75c	753430012-01	Spring washer	21	M12	SUS-304
75d	753430005-01	Spring washer	3	M5	SUS-304
75e	752430020-01	Washer	1	M20*30*0.5T	SUS-304
75f	753430020	Spring washer	1	M20	SUS-304
75g	752430012-01	Washer	6	M13*27*1.2T	SUS-304
75h	753430010-01	Spring washer	3	M10	SUS-304
76	7607-06	Ring fastener	2	M20	SUS-304
77	772434	Key	1	12*12*55	SUS-304
79	79463101	Bearing	1	6310 ZZ	
79a	79363121	Bearing	2	6312 ZZ	
81	810	Cable	1		