

Type	A	B	C	D
FS 675 NT	765	662	103	317

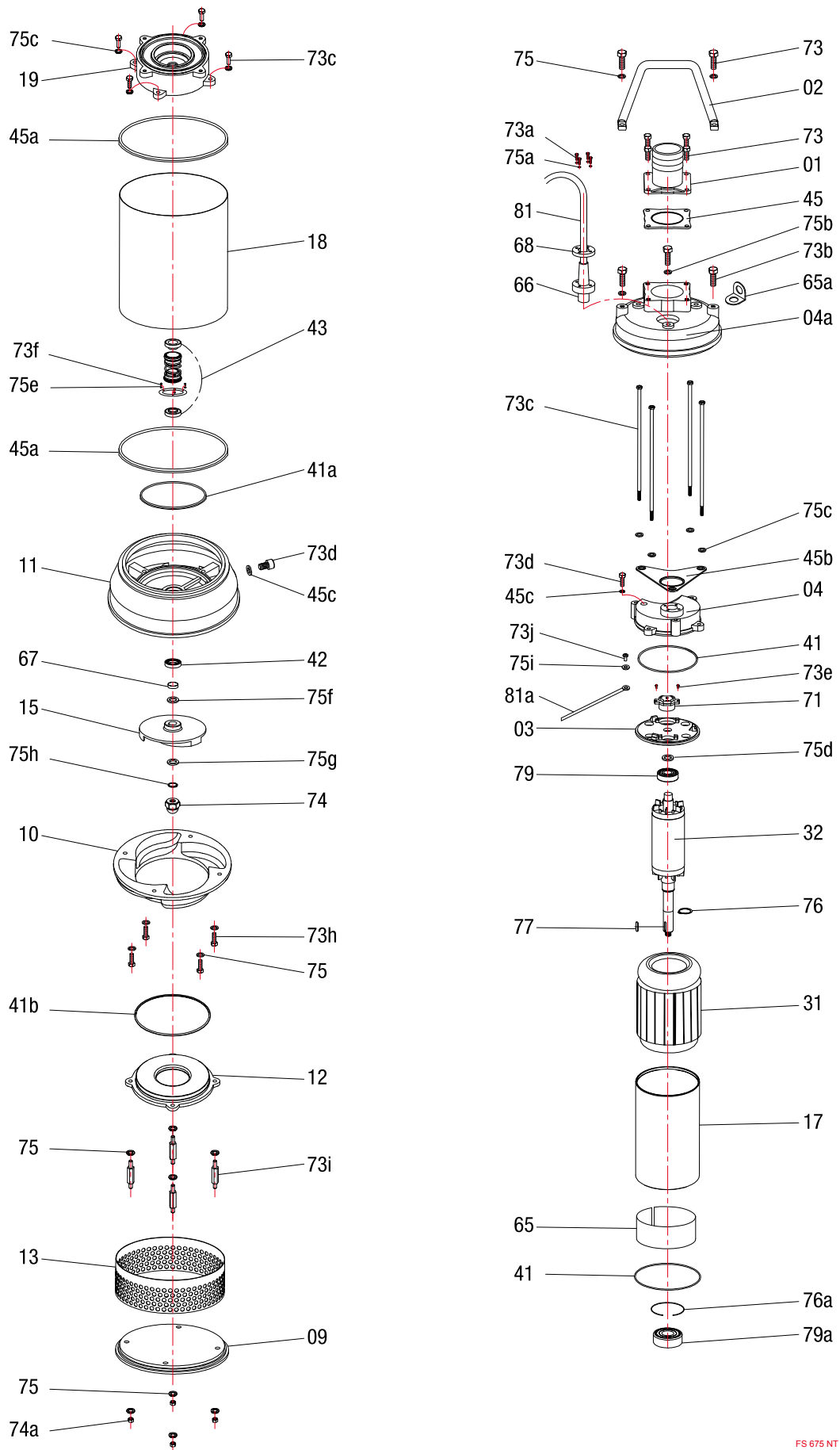

Index	Code NO	Description	Q'ty	Size	Material
01	01360952	Discharge head	1	6"	FC-20
02	02303-1	Handle	1		SC
03	0336FS-0550	Switch plate	1		FC-20
04	0436FS0750N	Motor cover	1		FC-20
04a	0436FS0750NF	Upper cover	1		FC-20
09	0935FS0750N	Base plate	1		FCD-45
10	1036FS0750N	Pump casing	1		FC-20
11	1136FS0750N	Seal bracket	1		FC-20
12	1236FS0750N	Inlet plate	1	6"	FC-20
13	13431512012	Strainer	1	15MM*120*307	SUS-304
15	1541FS-1125176	Impeller	1	176*5*25	High Chrome Steel
17	1743160320	Motor frame	1	160*320H	SUS-304
18	1843FS0750N	Outer case	1		SUS-304
19	1936FS0750N	Bearing bracket	1		FC-20
31	313440518F6	Stator	1	160*82*180L	
32	323FS0750N	Shaft/Rotor without Bearing	1		
41	411026-10	O'ring	3	2.62MM*158.7	N-70
41a	411031-08	O'ring	1	3.1MM*160	N-70
41b	411031-02	O'ring	1	3.1MM*190	N-70
42	4214335-01	Oil seal	1	35MM*60*12	SUS-304
43	432230-01	Mech.seal	1	Double 30 SIC/SIC VS CM/CB	
45	455FS-055010	Gasket	1		N-70
45a	456FS-055010	Gasket	2		N-70
45b	451FS0750N10	Gasket	1		N-70
45c	459010	Gasket	2		N-70
65	6531160	Shim	1	60MM	
65a	65433	Shim	1		SUS-304
66	66715145	Cable gland	1	14.5MM	NBR
67	674335-01	Shaft sleeve	1	35MM*25*21	SUS-304
68	684321	Gland Holder	1		SUS-304
71	7128-07	Thermal protector	1	KA314 HLXL00	
73	73431100301	Screw	6	Flat hex. M10*30	SUS-304
73a	73432060161	Screw	4	Socket hex.M6*16	SUS-304
73b	73431120401	Screw	3	Flat hex.M12*40	SUS-304
73c	73436084001	Screw	4	Flat hex. M8*400	SUS-304
73d	73432100161	Screw	2	Socket hex.M10*16	SUS-304
73e	73433040121	Screw	2	Round cross M4*12	SUS-304
73f	73431050121	Screw	3	Flat hex. M5*12	SUS-304
73g	73431080301	Screw	3	Flat hex. M8*30	SUS-304
73h	73431100401	Screw	4	Flat hex.M10*40	SUS-304
73i	73437101022	Screw	4	Twin headM10*85	SUS-304
73j	73303040081	Screw	1	Round cross M4*8	SC
74	7434316	Nut	1	M16	SUS-304
74a	7414310	Nut	4	M10	SUS-304
75	753430010-01	Spring washer	14	M10	SUS-304
75a	753430006-01	Spring washer	4	M6	SUS-304
75b	753430012-01	Spring washer	2	M12	SUS-304
75c	753430008-01	Spring washer	8	M8	SUS-304
75d	751306304	Wave washer	1	6304	SC
75e	753430005-01	Spring washer	3	M5	SUS-304
75f	752430025-01	Washer	1	M25*35*0.5T	SUS-304
75g	752430016-03	Washer	1	M16.8*33*1.9T	SUS-304
75h	753430016-01	Spring washer	1	M16	SUS-304
75i	757300004	Spring washer	1	M4	SC
76	7602-03	C'ing	1	STW-40	SC
76a	7601-03	C'ing	1	RTW-90	SC
77	771433-01	Key	1	7*7*18	SUS-304
79	79363041	Bearing	1	6304	
79a	79363081	Bearing	2	6308	
81	8108404200132	Cable	1	H07RN-F 4.0*4C*20M	
81a	811202	Earth lead	1		
Remarks					
		O'ring & Gasket sets	1		