

Type	A	B	C	D
FS 4220 T	1043	938	200	420

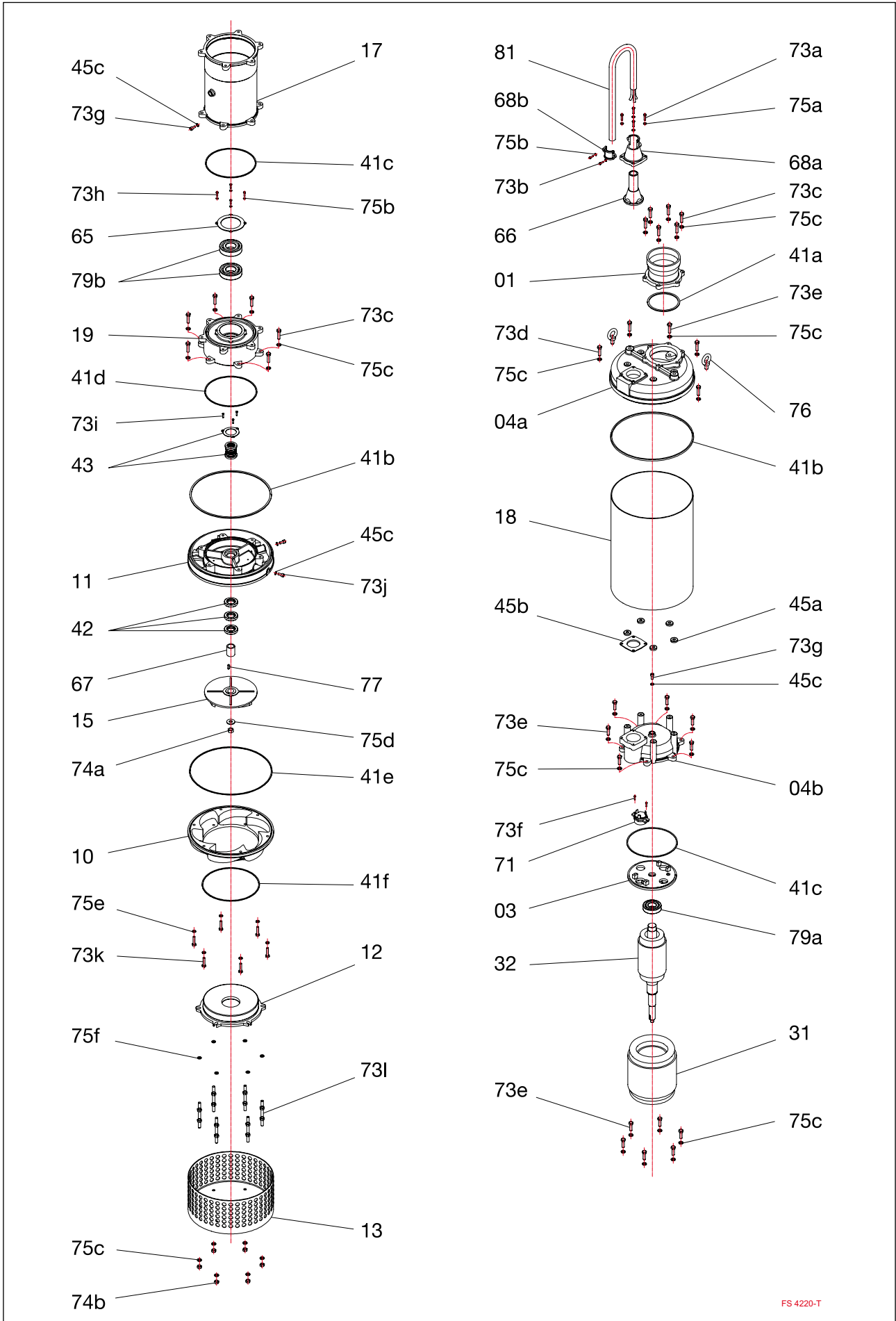

Index	Code NO	Description	Q'ty	Size	Material
01	1360852	Discharge head	1	4"	FC-20
03	0336FS2250	Switch plate	1		FC-20
04a	0436FS2250	Upper cover	1		FC-20
04b	0436FS2250F	Upper cover	1		FC-20
10	1036FS4220	Pump casing	1		FC-20
11	1136FS4220	Seal braket	1		FC-20
12	1236FS2550-4A	Inlet plate	1		FC-20
13	13431520022	Strainer	1	15MM*200*415	SUS-304
15	1541FS2550260	Impeller	1	265*4*30	High Chrome Steel
17	1736190380	Motor frame	1	190*380	FC-20
18	1843FS2250	Outer case	1		SUS-304
19	1936FS2250	Bearing bracket	1		FC-20
31	313415718F6	Stator	1	240*145*180L 400V	
32	323FS42250	Shaft/Rotor without Bearing	1	240*145*180L	
41a	411057-01	O'ring	1	145*5.7	N-70
41b	411040-03	O'ring	3	385*4	N-70
41c	411040-01	O'ring	3	240*4	N-70
41d	411031-04	O'ring	1	220*3.1	N-70
42	4214336-01	Oil seal	2	40*65*10	NBR
43	432235	Mech.seal	1	M35 - Double	
45a	451FS-112510-2	Gasket	5		N-70
45b	451FS-300010	Gasket	1		N-70
45c	459010	Gasket	4		N-70
65	65305	Shim	1		SC
66	66725220	Cable gland	1		N-70
67	67494030	Shaft sleeve	1	40MM*30*49	SUS-304
68a	68364	Gland Holder	1		FC-20
68b	686341	Gland Holder	1		FC-20
71	7128-08	Thermal protector	1	KA315 JNAL00	
73a	73431080551	Screw	4	Flat hex.M8*55	SUS-304
73b	73431060201	Screw	2	Flat hex.M6*20	SUS-304
73c	73431120301	Screw	12	Flat hex.12*35	SUS-304
73d	73431120651	Screw	4	Flat hex.12*65	SUS-304
73e	73431120401	Screw	13	Flat hex.12*40	SUS-304
73f	73303040121	Screw	2	Cross4*12	SC
73g	73432100161	Screw	2	Socket hex.10*16	SUS-304
73h	73431060101	Screw	4	Flat hex.6*10	SUS-304
73i	73431050121	Screw	3	Flat hex.5*12	SUS-304
73j	73432100201	Screw	2	Socket hex.10*20	SUS-304
73k	73431100401	Screw	6	Flat hex.10*40	SUS-304
73l	73437122001	Screw	6	Twin head M12*200	SUS-304
74a	7424320	Nut	1	M20	SUS-304
74b	7414312	Nut	6	M12	SUS-304
75a	753430008-01	Spring washer	4	M8	SUS-304
75b	753430006-01	Spring washer	6	M6	SUS-304
75c	753430012-01	Spring washer	35	M12	SUS-304
75d	753430020	Spring washer	1	M20	SUS-304
75e	753430010-01	Spring washer	6	M10	SUS-304
75f	752430014-01	Washer	6	M12	SUS-304
76	7607-5	Ring fastener	2	M16	SC
77	771433-01	Key	1	7*7*18	SUS-304
79a	79363081	Bearing	1	6308	
79b	79363101	Bearing	2	6310	
81	8108814200102	Cable	1	H07RN-F 10*4C*20M	
Remarks					
		O'ring & Gasket sets	1		